

### IMPORTANT

1. A pressure regulator sized for this unit is included. Natural gas 3.7" W.C., propane gas 10" W.C. manifold pressure.
2. This range is supplied with a 3/4" gas connection. For maximum performance or where supply pipe lengths are greater than 2 ft. long, we recommend a 1" supply line. If a flexible connection is used, the connection must be rated for the total gas input requirements of the range.
3. Hot tops and griddle plates cannot be positioned directly over convection oven controls. 36" ranges with convection ovens must have open burners in the "A" position.
4. An adequate ventilation system is required for commercial cooking equipment. Information may be obtained by writing to the National Fire Protection Association, Batterymarch Park, Quincy, MA 02289. When writing, refer to NFPA No. 96.
5. These units are manufactured for installation in accordance with ANSZ223.1A (latest edition), National Fuel Gas Code. Copies may be obtained from the American Gas Association, 1515 Wilson Blvd., Arlington, VA 22209.
6. Clearances: Combustible Non-combustible  
Rear 6" 6"  
Sides 10" 0"
7. This appliance is manufactured for commercial installation only and is not intended for home use.

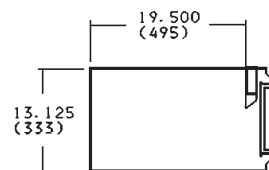

**SNORKEL OVEN CAVITY DIMENSIONS**  
 USABLE WIDTH (NOT SHOWN) 26.250 (667)  
 USABLE DEPTH 19.500 (495)  
 USABLE HEIGHT 13.125 (333)

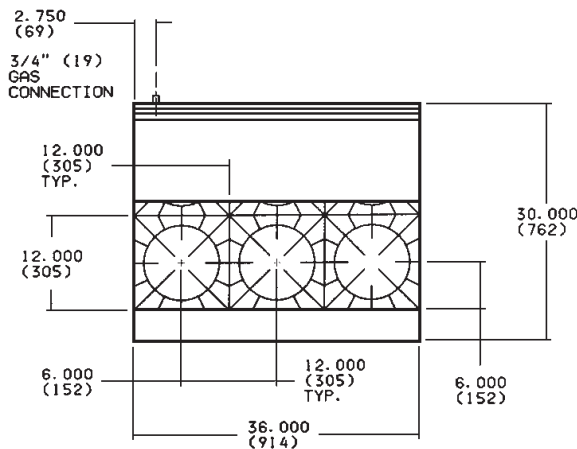
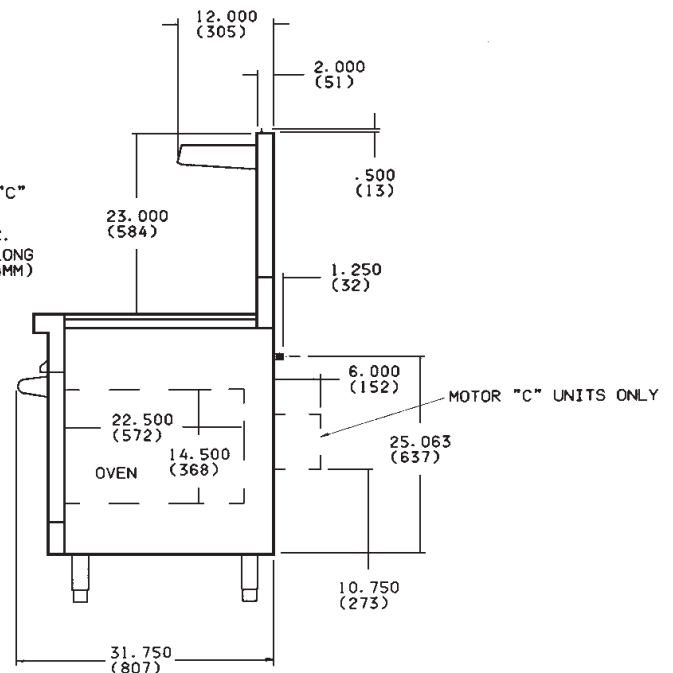
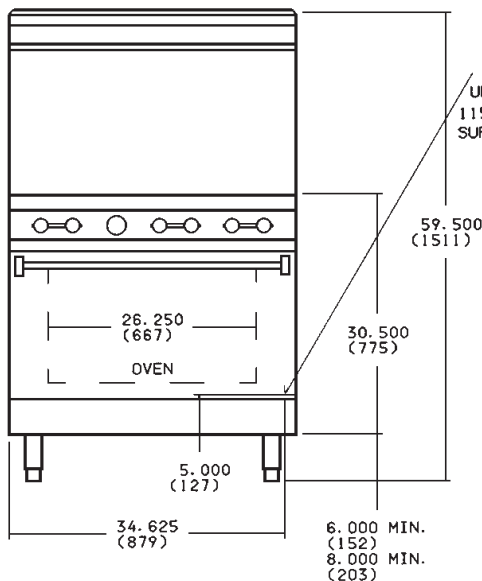

**NOTE:** In line with its policy to continually improve its products, Vulcan-Hart Company reserves the right to change materials and specifications without notice.